

Beacon

Architectural Indoor/Outdoor



Beacon is a versatile architectural lighting solution, perfect for both indoor and outdoor applications. Its clean, sleek, and modern design complements a wide range of decorative styles. It delivers soft and even illumination, creating a welcoming and well-lit environment. Beacon's adaptability is evident in its ability to be mounted either vertically or horizontally, making it suitable for various configurations. Popular among multifamily and commercial applications, it's a top choice for those seeking contemporary elegance and functionality in their lighting solutions. Whether indoors or outdoors, Beacon shines as a beacon of adaptable, modern design.

LED Engine

Color Temp (CCT): 3000K, 3500K, 4000K
CRI: 80+ (consult factory for 90+)
Life Expectancy: L70 rated at 50,000+ hours
Binning: 3-step Macadam
Output: Min 1636 lumens
Max 4580 lumens

Driver

Type: Constant current, Class 2, 120-277 Vac, 50/60Hz
Dimming: 0-10V and phase (leading or trailing edge)
Efficiency: Min 92%
Operating Temp: -40°C / -40°F to 50°C / 122°F
FCC Noise: Meets FCC Title 47 EMC Part 15 limits

Certifications

Location Listing: Wet Location Rated
Other: ADA Compliant
Buy America Compliant

Dimensions

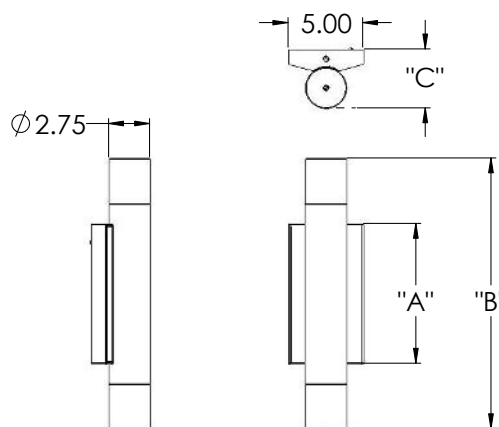

PRODUCT	"A"	"B"	"C"
BCN18	9.4"	18.3"	4.0"
BCN34	21.3"	34.0"	4.0"
BCN45	21.3"	45.4"	4.0"

Construction

Housing: heavy gauge heat treated aluminum with a fully gasketed mounting plate. **End caps:** O-ring sealed, extruded aluminum. **Diffuser:** matte white, impact resistant, UV stabilized extruded acrylic. **Finish:** high quality polyester powder coating. **Hardware:** tamper resistant, stainless steel. **Mounting:** vertical or horizontal position, mounts directly to a 4" octagonal j-box or with wall anchors without disassembly.

Catalog String

Fixture Core

BCN

1

--

2

3

4

UNIV

5

Aesthetics & Options

6

7

8

Product Specifications

1 — Product Code	2 — Trim	3 — Wattage	4 — Dimming	5 — Voltage
18 - BCN18 34 - BCN34 45 - BCN45	Not Applicable	L10.0 (18 only) L21.0 (34 only) L31.0 (45 only)	LT (LT- Leading/Trailing Edge) ZE (ZE - 0-10VDimming)	UNIV - (120V-277V)
6 — Finish	7 — CCT	8 — Options		
FBK - Fine Textured Black FBZ - Fine Textured Bronze FWH - Fine Textured White FSV - Fine Textured Silver	30K - 3000K 35K - 3500K 40K - 4000K	EB - Integral EM Battery F - Fused SPD - Surge Protection Device		

Performance

Wattage	Delivered Lumens	Efficacy LM/W	CCT	Size
L10.0	1636	154	3000K	18
L21.0	2706	135	3500K	34
L31.0	4397	144	4000K	45

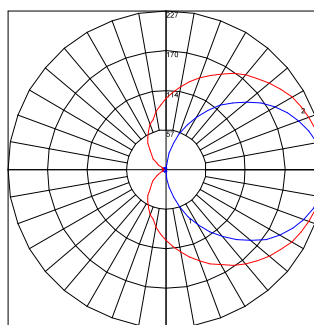

Polar Graph Details:

BCN18-L10.0-3000K
IES File Name: L012313001.IES

Maximum Candela = 227 Located At
 Horizontal Angle = 0, Vertical Angle = 90

1 - Vertical Plane Through Horizontal
 Angles (0 - 180) (Through Max. Cd.)

2 - Horizontal Cone Through Vertical
 Angle (90) (Through Max. Cd.)

Bug Rating: B0-U3-G1