



Exuding a bold yet refined presence, Tiger is tailored to perfection for spaces seeking both character and clarity in lighting. With its compelling design, it stands as a preferred choice for commercial and retail entryways, ensuring a warm welcome to every visitor. The strategic luminosity it offers impeccably lights up corridors and multifamily common areas, creating an ambiance of safety and sophistication. For those environments where first impressions matter and where everyday paths need clear, consistent lighting, Tiger asserts itself as an unparalleled choice.

LED Engine

- Color Temp (CCT):** 3000K, 3500K, 4000K
- CRI:** 80+ (consult factory for 90+)
- Life Expectancy:** L70 rated at 50,000+ hours
- Binning:** 3-step Macadam
- Output:** Min 1400 Source Lumens
Max 1986 Source Lumens

Driver

- Type:** Constant current, Class 2, 120-277 Vac, 50/60Hz
- Dimming:** 0-10V
- Efficiency:** Min 92%
- Operating Temp:** -40°C / -40°F to 50°C / 122°F
- FCC Noise:** Meets FCC Title 47 EMC Part 15 limits

Certifications

- Location Listing:** Damp Location Rated for Wall Mounting
- Other:** ADA Compliant
Buy America Compliant

Dimensions

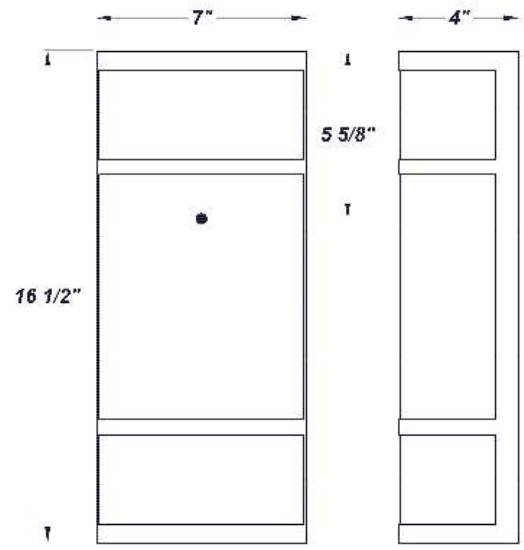

Construction

Mounting Plate: Die-formed steel with hi-reflectance white finish. **Diffuser:** Luminous White Acrylic. **Trim:** Formed steel. **Finish:** high quality polyester powder coating, various finishes. **Mounting:** Wall-mounted over a 4-inch junction box.

Catalog String

Fixture Core

TGR

1

2

3

4

UNIV

5

Aesthetics & Options

6

7

8

Product Specifications

1 — Product Code	2 — Trim	3 — Wattage	4 — Dimming	5 — Voltage
TGR	STD (Blank) CNC DCB SOA TBT VHT	L12.0 L18.0	ZE - 0-10V Dimming LT - Leading/Trailing	UNIV - (120V-277V)

6 — Finish	7 — CCT	8 — Options
FBK - Fine Textured Black FBZ - Fine Textured Bronze FWH - Fine Textured White FSV - Fine Textured Silver	30K - 3000K 35K - 3500K 40K - 4000K	F - Fused S - Surge Protector TBC - Perforated Steel Top & Bottom Cover TCV - Perforated Steel Top Cover

Performance

Wattage	Source Lumens	Efficacy LM/W	CCT
L12.0	1400	116.7	3000K
L18.0	1986	110.3	

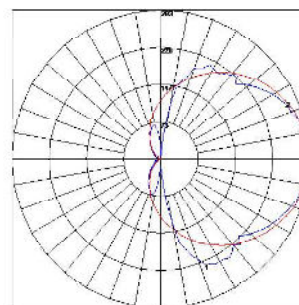

Polar Graph Details:

IES File Name: IES-TGR-L18.0-TE500-SM-30K.IES

Maximum Candela = 293 Located At Horizontal Angle = 0, Vertical Angle = 91

1 - Vertical Plane Through Horizontal Angles (0 - 180) (Through Max. Cd.)

2 - Horizontal Cone Through Vertical Angle (91) (Through Max. Cd.)

Trims



Tiger STD *(Blank)*



Tiger CNC



Tiger DCB



Tiger SOA



Tiger TBT



Tiger VHT