

PROJECT :
TYPE :
ORDERING # :
COMMENTS :

## BISCAYNE N LED



W/ DMD TRIM

## FEATURES

- Steel Housing & End Caps w/ Matte Silver Powder Coat Finish
- High Impact Frosted Acrylic Diffuser
- Steel Reflector Plate w/ Hi-Reflectance White Powder Coat Finish
- Mounts Directly to Wall or Ceiling w/ Four Wall Anchors (Not Included)
- 0-10V and Trailing Edge (ELV) Dimming Compatible Options Available
- Constant Current, Dimmable 0-10V, 25% or 50% Step Dimmable
- CSA Listed Damp Location For Wall or Ceiling Mount
- L70 Life Time For 50,000hr
- ADA Compliant
- IES Files Available

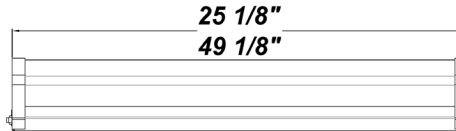
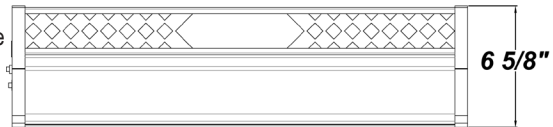

## ORDERING INFORMATION

Example : (BSCN24 - L20.1 - ZE550 - 120-277V - WAL - DMD - SW - 30K - TP) **Matte Silver is Standard Finish**

PRODUCT	SOURCE/WATTAGE	VOLTAGE	DIMMING	DIFFUSER / TRIM	FINISH	OPTIONS
Biscayne N 25" (BSCN24)	BSCN24-L18.3-TL500 22W @ 500mA Constant Current ELV Dimming Electronic Driver (Dimmable at 120V)	120 - 277V  (50 / 60Hz)	SD10 - Bi-level Step Dimming (10 - 100%) (Must be Used With MSE Option)	FAL - Frosted Acrylic Lens (Standard) WAL - Frosted & White Acrylic Lens Assembly	SM - Matte Silver TB - Textured Black AC - Antique Copper AS - Antique Silver BT - Bronze Mist CP - Copper KC - Kenworth Chrome SN - Sand SW - Swedish Steel BZ - Textured Bronze TW - Textured White	50K - 5000K Color Temp. 40K - 4000K Color Temp. 35K - 3500K Color Temp. 30K - 3000K Color Temp. 27K - 2700K Color Temp. MSE - Wattstopper FS-505C External Motion Sensor w/ Power Pack (120V / 277V Only) MSI - Wattstopper FM-105 Internal Motion Sensor (120V / 277V Only) EB - Emergency Driver TP - Tamper Resistant Screws F - Fused (120V / 277V Only)
	BSCN24-L20.1-ZE550 22W @ 550mA Constant Current Dimming Electronic Driver (Dimmable 0-10V)  L70 life time for 50,000hr			SD25 - Bi-level Step Dimming (25 - 100%)  SD50 - Bi-level Step Dimming (50 - 100%)	HCB - Honeycomb Pattern Trim DMD - Diamond Pattern Trim PRF - Perforated Pattern Trim  <b>Please Note:</b> Trim Runs Length of Fixture Unless a Motion Sensor is Ordered. Trim is Then Separated Into 2 Parts, as Illustrated Above.	<b>RAL Colors or Custom Match - Consult Factory</b>

SOURCE/WATTAGE	30K SPECIFICATIONS
<b>L20.1</b> - 20.1W LED Strip(s) - Constant Current 550 Milliamps Driver - 20.1 Input	<b>L20.1</b> 30K - 3000K Color Temp.  - 34 fV, Color Temp = 3000K Nominal - 2981 LED Source Lumens - 148.3 LED Source Lumens Per Watt
<b>L18.3</b> - 18.3W LED Strip(s) - Constant Current 500 Milliamps Driver - 18.3W Input	<b>L18.3</b> 30K - 3000K Color Temp.  - 34 fV, Color Temp = 3000K Nominal - 2711 LED Source Lumens - 148.1 LED Source Lumens Per Watt

REPLACEMENT PARTS	PART NO.
Frosted 2' Acrylic Diffuser	3029662
Frosted 4' Acrylic Diffuser	3001562
White 2' Acrylic Lens Assembly	38112
White 4' Acrylic Lens Assembly	38113

We reserve the right to revise the design or components of any product due to parts availability or change in UL standards, without assuming any obligation or liability to modify any products previously manufactured, and without notice.



**BISCAYNE N LED**

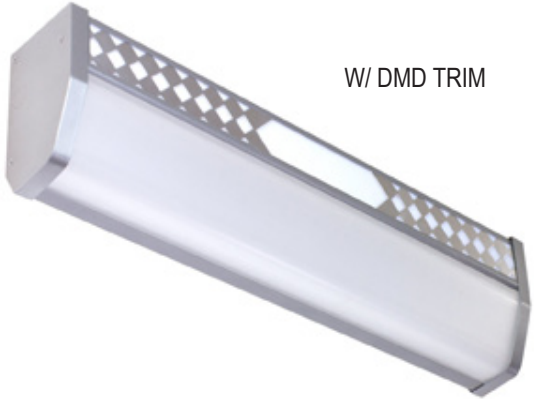

W/ DMD TRIM

PROJECT :
TYPE :
ORDERING # :
COMMENTS :

**FEATURES**

- Steel Housing & End Caps w/ Matte Silver Powder Coat Finish
- High Impact Frosted Acrylic Diffuser
- Steel Reflector Plate w/ Hi-Reflectance White Powder Coat Finish
- Mounts Directly to Wall or Ceiling w/ Four Wall Anchors (Not Included)
- 0-10V and Trailing Edge (ELV) Dimming Compatible Options Available
- Constant Current, Dimmable 0-10V, 25% or 50% Step Dimmable
- CSA Listed Damp Location For Wall or Ceiling Mount
- L70 Life Time For 50,000hr
- IES Files Available
- ADA Compliant

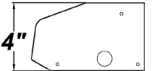
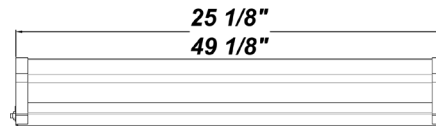

**ORDERING INFORMATION**

Example : (BSCN48 - L38.3 - ZE1100 - 120 - 277V - WAL - DMD - SW - TP - 30K)

Matte Silver is Standard Finish

PRODUCT	SOURCE/WATTAGE	VOLTAGE	DIMMING	DIFFUSER / TRIM	FINISH	OPTIONS
Biscayne N 49"	BSCN48-L38.3-ZE1100 42W @ 1100mA Constant Current Dimming Electronic Driver (Dimmable 0-10V)	120 - 277V (50 / 60Hz)	SD10 - Bi-level Step Dimming (10 - 100%)	FAL - Frosted Acrylic Lens (Standard) WAL - Frosted & White Acrylic Lens Assembly	SM - Matte Silver TB - Textured Black AC - Antique Copper AS - Antique Silver BT - Bronze Mist CP - Copper KC - Kenworth Chrome SN - Sand SW - Swedish Steel BZ - Textured Bronze TW - Textured White	50K - 5000K Color Temp. 40K - 4000K Color Temp. 35K - 3500K Color Temp. 30K - 3000K Color Temp. 27K - 2700K Color Temp. MSE - Wattstopper FS-505c External Motion Sensor w/ Power Pack (120V / 277V Only) MSI - Wattstopper FM-105 Internal Motion Sensor (120V / 277V Only) EB - Emergency Driver TP - Tamper Resistant Screws F - Fused (120V / 277V Only)
	BSCN48-L34.7-TE950 40W @ 950mA Constant Current ELV Dimming Electronic Driver  L70 life time for 50,000hr		SD25 - Bi-level Step Dimming (25 - 100%)  SD50 - Bi-level Step Dimming (50 - 100%)	HCB - Honeycomb Pattern Trim DMD - Diamond Pattern Trim PRF - Perforated Pattern Trim  Please Note: Trim Runs Length of Fixture Unless a Motion Sensor is Ordered. Trim is Then Separated Into 2 Parts, as Illustrated Above.		

SOURCE/WATTAGE	30K SPECIFICATIONS
L38.3 - 38.3W LED Strip(s) - Constant Current 1050 Milliamps Driver - 38.3W Input	<b>L38.3</b> 30K - 3000K Color Temp.  - 34 fV, Color Temp = 3000K Nominal - 5693 LED Source Lumens - 148..6 LED Source Lumens Per Watt
L34.7 - 34.7W LED Strip(s) - Constant Current 950 Milliamps Driver - 34.7W Input	<b>L34.7</b> 30K - 3000K Color Temp.  - 34 fV, Color Temp = 3000K Nominal - 5150 LED Source Lumens - 148..4 LED Source Lumens Per Watt

REPLACEMENT PARTS	PART NO.
Frosted 2' Acrylic Diffuser	3029662
Frosted 4' Acrylic Diffuser	3001562
White 2' Acrylic Lens Assembly	38112
White 4' Acrylic Lens Assembly	38113

We reserve the right to revise the design or components of any product due to parts availability or change in UL standards, without assuming any obligation or liability to modify any products previously manufactured, and without notice.



# FS-505



## DESCRIPTION AND OPERATION

The FS-505 and FS-505C occupancy sensors turn lighting on and off based on occupancy. The sensors use ultrasonic sensing technology. Once the space is vacant and the time delay elapses (adjustable from 5 to 30 minutes), lights will turn off.

The FS-505 and FS-505C operate at 24VDC. They are designed for installation in a light fixture within 2 feet of an associated power supply. The power supply for the sensors is a FS-PP power pack mounted inside a light fixture. Each Watt Stopper FS-PP power pack can supply power for one FS-505 or FS-505C.

The sensors are equipped with a 2' long cable fitted with a shielded male RJ45 plug. The FS-PP has a corresponding female RJ45 receptacle. This cable carries power to the sensor and the 24VDC maintained output to the power pack to signal that lights should be on. Optional cables and connectors are available for alternate configurations.

### Important, there is an initial warm-up period:

It may take up to a minute before the lights turn on due to a sensor warm-up period required during initial power-up. This occurs during installation or after a lengthy power failure only.

## APPLICATION

The FS-505 (no cones) is designed for use in wall-mounted lighting fixtures where the transducers face away from the wall at an angle of approximately 20° from vertical. It is particularly well suited for use in stairwell applications as well as in other wall mount applications.

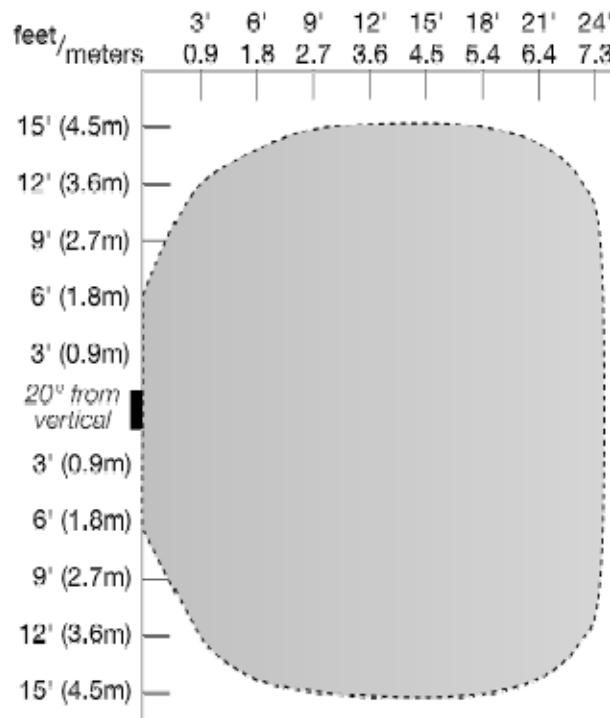
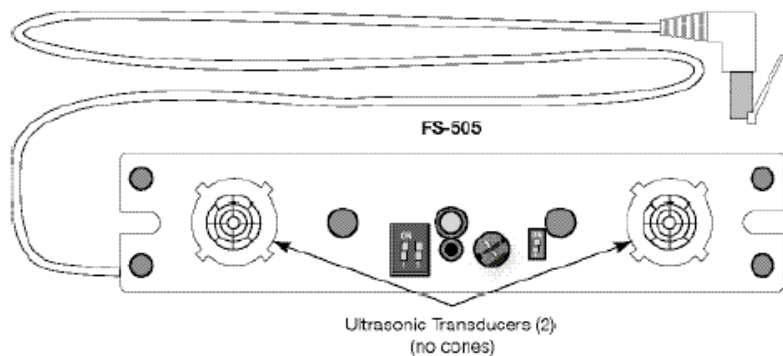

Top view, FS-505 coverage pattern, sensor mounted 20° from vertical

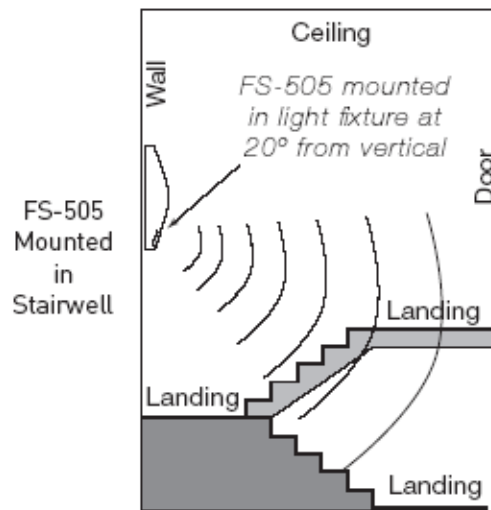

## COVERAGE PATTERN

The coverage pattern is determined by sensor model, mounting height and the angle of the sensor, relative to the coverage area floor.

The coverage shown represents full-step walking motion in a carpeted area, with no barriers or obstacles at a mounting height of 8 to 10 feet. Mounting above or below this range significantly affects coverage patterns.

Obstacles such as furniture or partitions, wall, ceiling and floor treatments can cause the coverage area to be less or more than the sensing distances shown in the coverage pattern. This must be considered when planning the number of sensors and their placement.

Place sensors at least 4 feet away from air supply ducts.

For complete coverage in open areas, install multiple sensors to provide a 20% overlap with each adjacent sensor's coverage area.



Call 800.879.8585 or 972.578.1699  
for Technical Support



# FM-105 Super High Frequency Occupancy Sensor

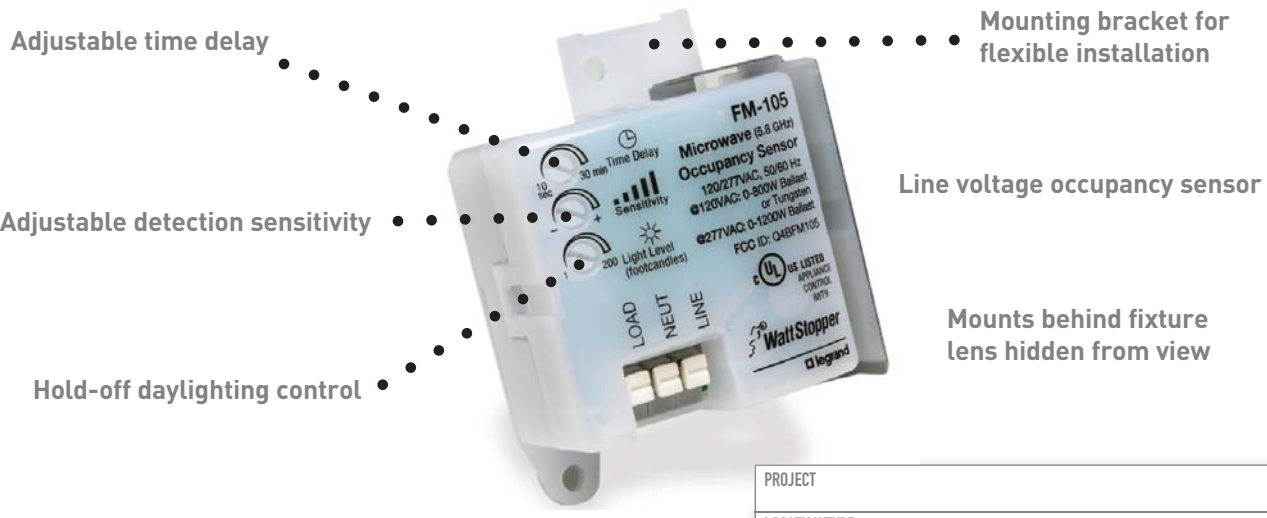

PROJECT
LOCATION/TYPE

## Product Overview

### Description

The FM-105 Super High Frequency Occupancy Sensor is a line voltage sensor that turns lighting on and off based on occupancy, and can hold lights off when sufficient daylight is available. It detects motion via super high frequency (SHF) electromagnetic waves and the Doppler principle. Because it can detect motion through many dense materials other than metal, the FM-105 can be installed behind fixture lenses and hidden from view.

### Operation

The FM-105 operates at 120 or 277 VAC and utilizes SHF technology to control lighting based on occupancy. It sends out electromagnetic waves that bounce off nearby surfaces, and uses the Doppler principle to analyze changes in the return waves to detect motion in the area (similar to the way that ultrasonic sensor technology performs). When motion is detected, the FM-105 turns on the load, unless the ambient light level is greater than the daylighting setpoint (if enabled), or turns off the load when no motion is detected for the preset time delay.

## Features

- Detects movement when installed behind low-density fixture materials, such as polycarbonate, acrylic and glass diffusers
- Provides hold-off daylighting control when ambient light is greater than daylighting setpoint
- Can be mounted hidden from view
- Easy adjustment via trimpots

## Flexible Functionality

The FM-105 Sensor coverage pattern is omnidirectional. Depending on its installation, it can be adjusted to detect occupancy up to 20 feet away. The FM-105 can be placed inside a lighting fixture or behind an object made of wood or plastic so that it is completely hidden from direct view. Its integrated daylight sensitivity adjusts from 2 to 200 footcandles, and its time delay may be set from 10 seconds to 30 minutes.

## Applications

The FM-105 operates best when installed behind low-density fixture materials, such as polycarbonate, acrylic and glass diffusers. FM-105 technology also provides superior detection in hard surfaced areas such as stairwells and hallways. This sensor is also suited for installation behind lenses in outdoor wall sconces, wall packs and pedestrian-scale luminaires.

- Mounting bracket facilitates installation in various mounting positions
- Simple line voltage wiring does not require a power pack
- Time delay adjustable from 10 seconds to 30 minutes
- Adjustable sensitivity range up to 20 feet
- RoHS compliant



# Specifications

- 120/277 VAC, 50/60 Hz
- Load requirements
  - @ 120 VAC, 60 Hz: 0-800 W ballast or tungsten
  - @ 277 VAC, 60 Hz: 0-1200 W ballast
- Light Level: 2-200 fc
- Range/Sensitivity: Up to 20' (6.1m)
- Time delay: 10 seconds to 30 minutes
- Operating frequency: 5.8 GHz
- Power output: 1 mW
- Dimensions: 2.0" x 3.09" x 1.63" (51.0mm x 78.5mm x 41.4mm) L x W x D
- Weight: 2.3 oz (65.2 g)
- Operating temperature range: -4-131°F (-20-55°C)
- FCC approved
- UL and CUL listed
- Five year warranty

# Mounting & Wiring

## Mounting

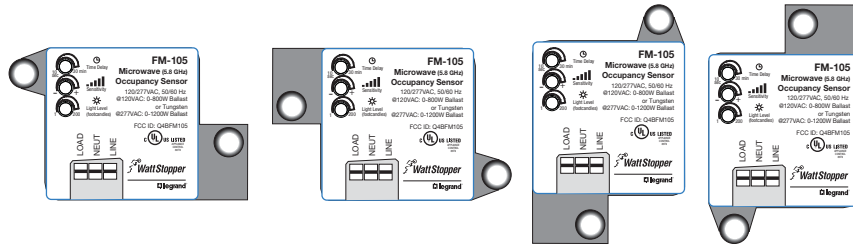

Mounting foot provides four different mounting positions.

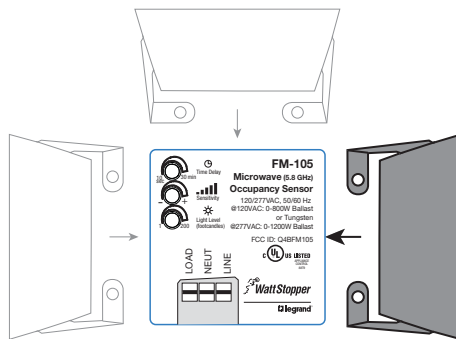

Position metal shield between FM-105 and lamp/ballast.

## Wiring Diagram

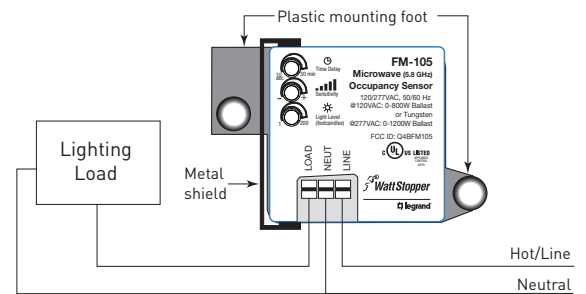

# Coverage

## Ceiling Mount

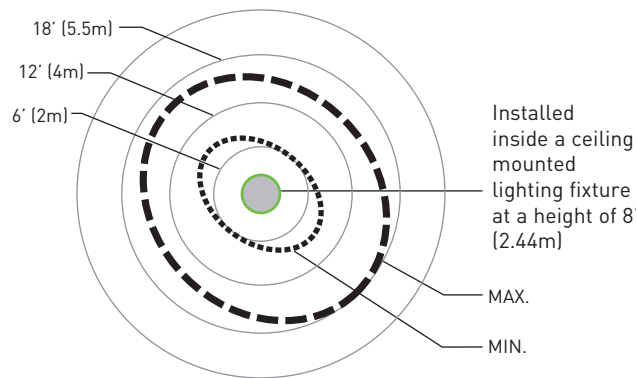

## Wall Mount

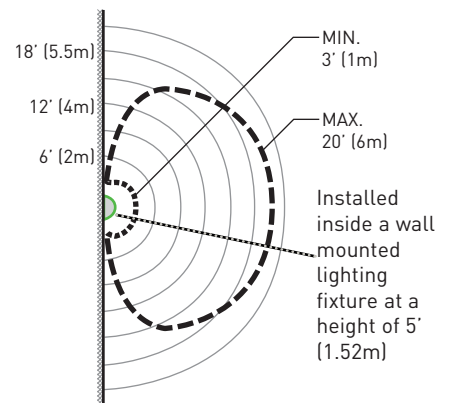

Coverage pattern will vary based on installation of sensor and surrounding materials.

# Ordering Information

Catalog No.	Description	Voltage	Load Capacity
□ FM-105	Super High Frequency Occupancy Sensor	120 VAC 277 VAC	0-800 W ballast or tungsten 0-1200 W ballast