

## HERITAGE OVAL LED



VYE

MEDIUM  
HOUSING

RNG



CRS



EYE

Matte White and Titanium  
Finishes Shown

PROJECT :
TYPE :
ORDERING # :
COMMENTS :

## FEATURES

- Die-Cast, Marine Grade Aluminum Housing
- Injection Molded Polycarbonate Fascia w/ Weep Holes
- Translucent White Injection Molded, UV-Stabilizing Polycarbonate Diffuser
- 0.040" Aluminum Reflector Plate w/ Hi-Reflectance White Powder Coat Finish
- Extruded, EPMD Ribbed / Foam Rubber Gasketing
- Junction Box Pattern on Housing For Easy Mounting
- Thermal Compensation Technology Ensures Longer LED Lifetime, Which is Ideal For Fixtures Being Placed in Area With Fluctuating or Higher Ambient Temperatures
- 100V - 277V
- One 40W LED Driver
- Surge Protector
- CSA Listed Wet Location For Wall or Ceiling Mount

0.75" CONDUIT ENTRIES  
4 TOTAL - SPACED 90 DEGREES  
AROUND SIDE OF HOUSING

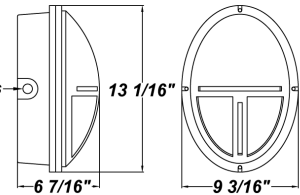

## ORDERING INFORMATION

Example : (HRO - L33.6 - 100 - 277V - RNG - FRL - TI - 30K)

PRODUCT	SOURCE/WATTAGE	VOLTAGE	FASCIA/DIFFUSER	FINISH	OPTIONS
HRO					
<b>Heritage Oval</b>	<b>L33.6 - (8) 4.2W LED Strips</b>  4.2W LED Strips - (LM80 Standard) **40,000 Hours (L70)	<b>100 - 277V</b>	<b>CRS</b> - Cross Guard Fascia <b>EYE</b> - Eyelid Guard Fascia <b>RNG</b> - Open Guard Fascia <b>VYE</b> - Vertical Eyelid Guard Fascia  <b>FRL</b> - Frosted Ribbed Diffuser <b>WPL</b> - White Diffuser	<b>BK</b> - Matte Black <b>BZ</b> - Matte Bronze <b>WH</b> - Matte White <b>TI</b> - Matte Titanium	<b>30K</b> - 3000K Color Temp. <b>40K</b> - 4000K Color Temp. <b>51K</b> - 5100K Color Temp. <b>TP</b> - Tamper Resistant Screws

## REPLACEMENT PARTS

## PART NO.

White Polycarbonate Diffuser	3408660
Frosted Ribbed Polycarbonate Diffuser	3408662

ARRA 2009



BUY AMERICA ACT



## NOTES

\*\*Definition of 40,000 hours: Lifetime Rating is Based on Lamp Manufacturers' LM80 Test Results Which Utilized an Exponentially Decaying Model, a Standard Used by The Department of Energy, as Well as by Other Manufacturers.

We reserve the right to revise the design or components of any product due to parts availability or change in UL standards, without assuming any obligation or liability to modify any products previously manufactured, and without notice.



PROJECT :
TYPE :
ORDERING # :
COMMENTS :

PRODUCT	SOURCE/WATTAGE	30K SPECIFICATIONS	40K SPECIFICATIONS	51K SPECIFICATIONS
Heritage Oval LED	L33.6 - (8) 4.2W LED Strips  4.2W LED Strips - (LM80 Standard) **40,000 Hours( L70)	<b>Eight 4.2W LED Strips</b> <b>30K - 3000K Color Temp.</b>  3 Nichia NS3x183 Series LEDs Per Strip - SW30Bin, Color Temp = 3000K Nominal - Constant Voltage at 12 Volts by Driver - 80 CRI typ. (75 CRI min) 2074 Lumens - 35W Input = Estimated 59 Lumens Per Watt	<b>Eight 4.2W LED Strips</b> <b>40K - 4000K Color Temp.</b>  3 Nichia NS3x183 Series LEDs Per Strip - SW30Bin, Color Temp = 4000K Nominal - Constant Voltage at 12 Volts by Driver - 80 CRI typ. (75 CRI min) 2130 Lumens - 35W Input = Estimated 61 Lumens Per Watt	<b>Eight 4.2W LED Strips</b> <b>51K - 5100K Color Temp.</b>  3 Nichia NS3x183 Series LEDs Per Strip - SW51Bin, Color Temp = 5100K Nominal - Constant Voltage at 12 Volts by Driver - 80 CRI typ. (75 CRI min) 2240 Lumens - 35W Input = Estimated 64 Lumens Per Watt

ARRA 2009



BUY AMERICA ACT C US