

PROJECT :
TYPE :
ORDERING # :
COMMENTS :

PINSEEKER RD



COMPACT FLUORESCENT

FEATURES

- Polycarbonate Housing w/ Black Finish
- Injection Molded White Polycarbonate Lens
- Steel Mounting Pan w/ Hi-Reflectance White Powder Coat Finish
- Fully Gasketed Lens Channel
- Mounts Directly to 4" Junction Box (By Others)
- Mounting Hardware Included
- Lamps Included
- CSA Listed Wet Location For Wall or Ceiling Mount
- ADA Compliant

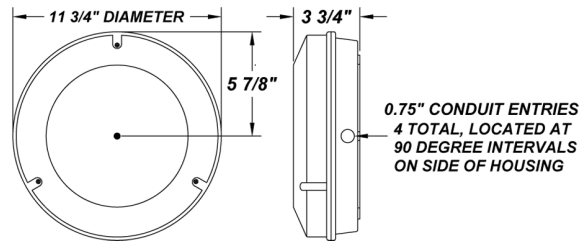

ORDERING INFORMATION

Example : (PRR113Q - 277E - 35K) Black is Standard Finish

PRODUCT	SOURCE/WATTAGE	VOLTAGE	DIFFUSER	FINISH	OPTIONS
Pinseeker Rd	PRR113Q - (1) 13W QE PRR213Q - (2) 13W QE PRR118Q - (1) 18W QE PRR126Q - (1) 26W QE	120E - Electronic 120V 277E - Electronic 277V 347E - Electronic 347V	Not Applicable	BK - Black (Standard) WH - White Note: Custom Colors Are Not Available	41K - 4100K Color Temp. 35K - 3500K Color Temp. 30K - 3000K Color Temp. 27K - 2700K Color Temp. (Standard) TP - Tamper Resistant Screws PCL - Photocell MSP - Program Start Ballast (Recommended for Motion Sensor) ***

REPLACEMENT PARTS	PART NO.
White Polycarbonate Diffuser	3401560

NOTES

We reserve the right to revise the design or components of any product due to parts availability or change in UL standards, without assuming any obligation or liability to modify any products previously manufactured, and without notice.



*** For Electronic Wattage Fixtures Being Used in Conjunction With an Occupancy Sensor (Either Provided by us, or Your Own System), a Program Start Ballast is Recommended in Order to Maximize Lamp Life.